

GHAFF LAND

Residence



Project Details

Building Configuration	Basement + Ground + 8 Floors + Roof
Total No. of Units	168 Units
No. of Units per Floor	6-22
Amenities	Swimming Pool, Gym, Kids’ Play Area & Recreational Multi-purpose Space
Finishes	Kitchen cabinets by Scavolini and sanitaryware by Heimberg
Systems	Smart Home
Unit Mix	Studio, 1-Bedroom, 2-Bedroom & 2-Bedroom Duplex
Anticipated Completion Date	Q4 2025

The Location

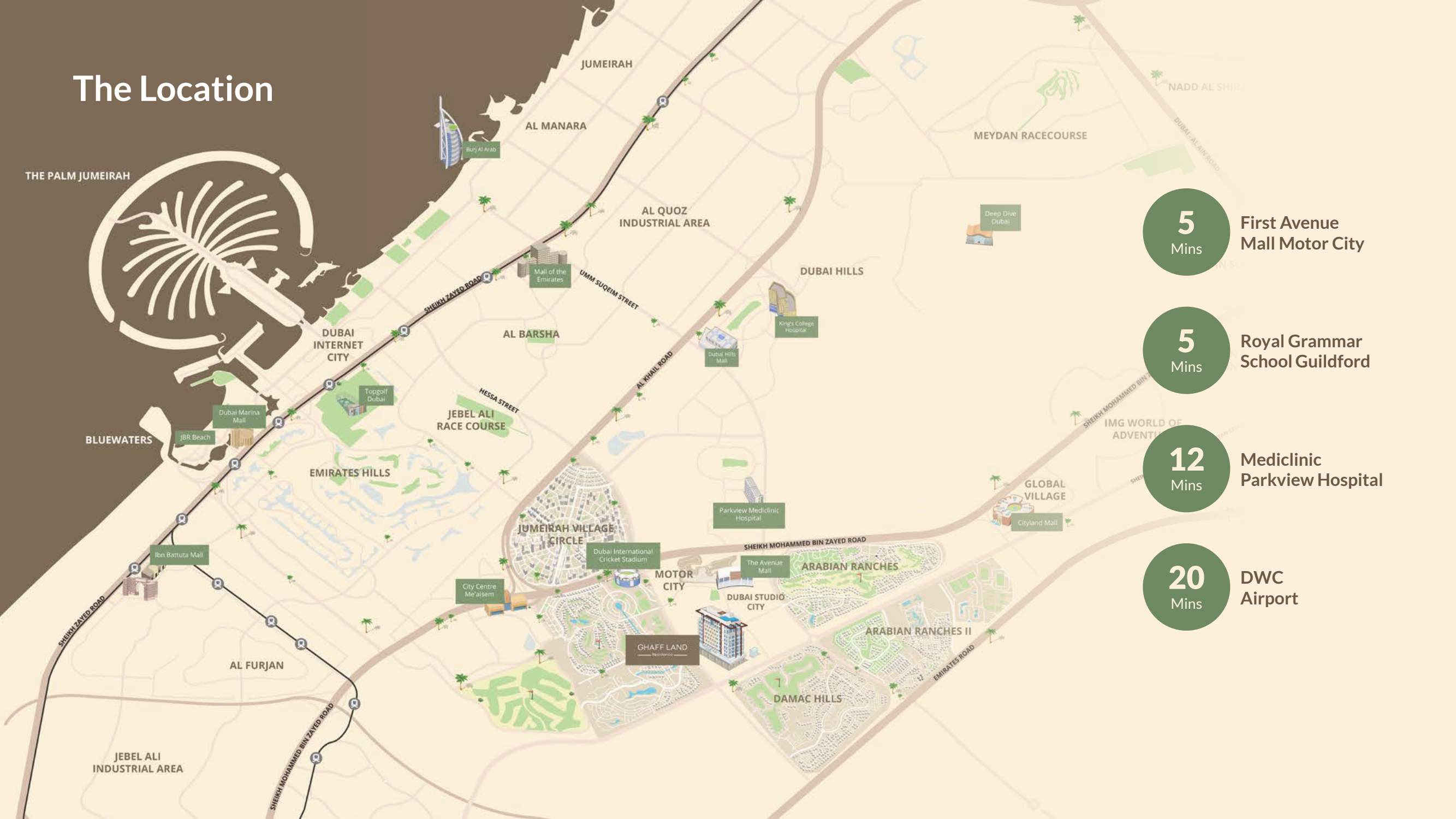

GHAFF LAND

— Residence —

Exterior Renders



GHAFF LAND
Residence









GHAFF LAND

— Residence —

Amenities



GHAFF LAND
— Residence —







The background of the entire page is a light beige or cream color. It features soft, out-of-focus shadows of palm fronds, creating a tropical and serene atmosphere. The shadows are most prominent on the right side and fade towards the left.

GHAFF LAND

— Residence —

Apartment Interiors



Duplex Living Room



Typical Living Room



Typical Kitchen



Typical Bedroom



Typical Studio



Typical Studio

Typical Bathroom



GHAFF LAND

—— Residence ——

Unit Types

Unite Types

Unite Types	Average Size
Studio	454 Sq. Ft.
1-Bedroom	768 Sq. Ft.
2-Bedroom	1,037 Sq. Ft.
2-Bedroom Duplex	2,012 Sq. Ft.

GHAFF LAND

— Residence —

Floor Plans

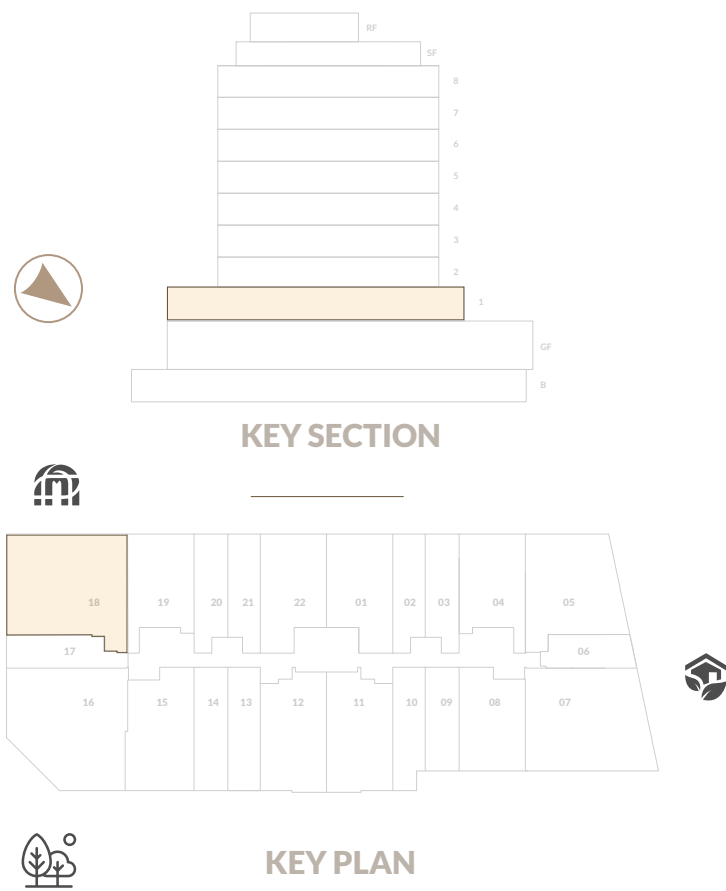

UNIT AREA: 857 sq.ft.

BALCONY AREA: 1294 sq.ft.

TOTAL AREA: 2152 sq.ft.

2 BEDROOM APARTMENT

TYPE

D

UNIT NO. 207 & 216

FLOOR

02 - 06

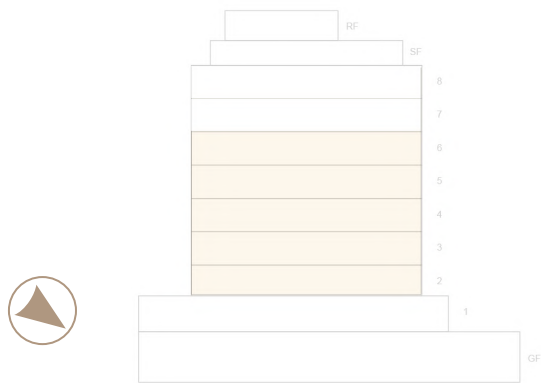

KEY SECTION

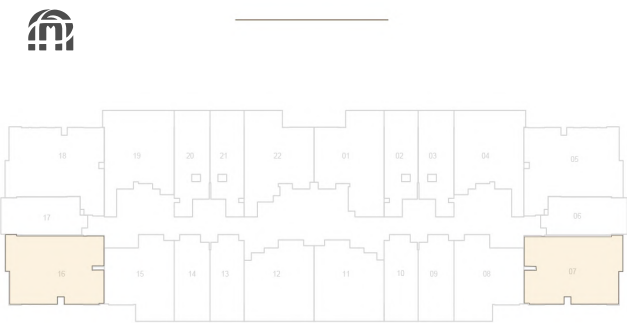

KEY PLAN

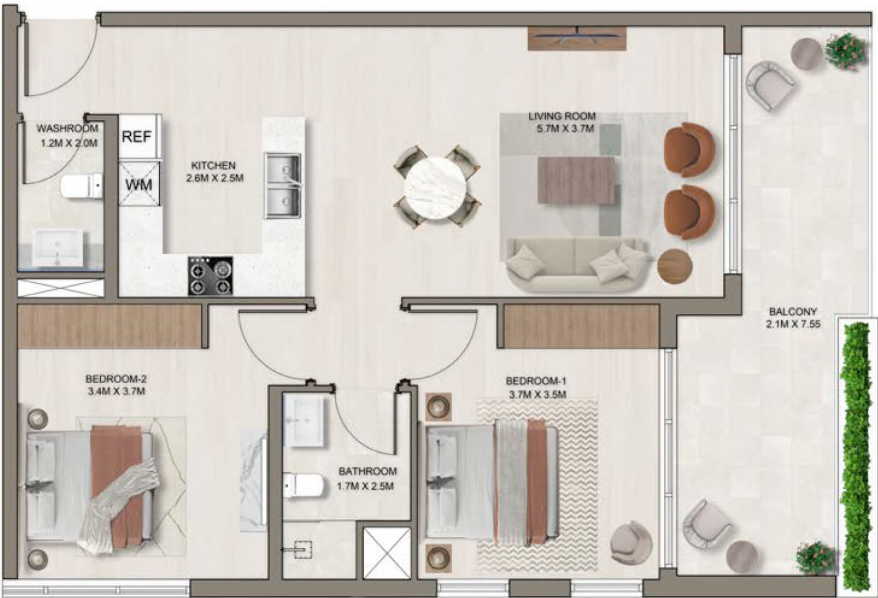

UNIT AREA: 794 sq.ft.

BALCONY AREA: 179 sq.ft.

TOTAL AREA: 973 sq.ft.

GHAFF LAND
Residence

All drawings and dimensions are approximate. Drawings are not to scale and are subject to change without notice. The developer reserves the right to make revisions. The units are measured at typical floor in the building and columns may vary in size depending on the floor level. The furnishings and accessories shown are for representation only. The length and width of the Unit and balcony varies depending on which floor and which orientation the unit is located within the building to comply with the building authority regulations. Apartment unit sizes may vary. Actual unit sizes will be reflected on the Sales and Purchase Agreement.

STUDIO

TYPE D

UNIT NO. 207 & 216

FLOOR 02 - 06

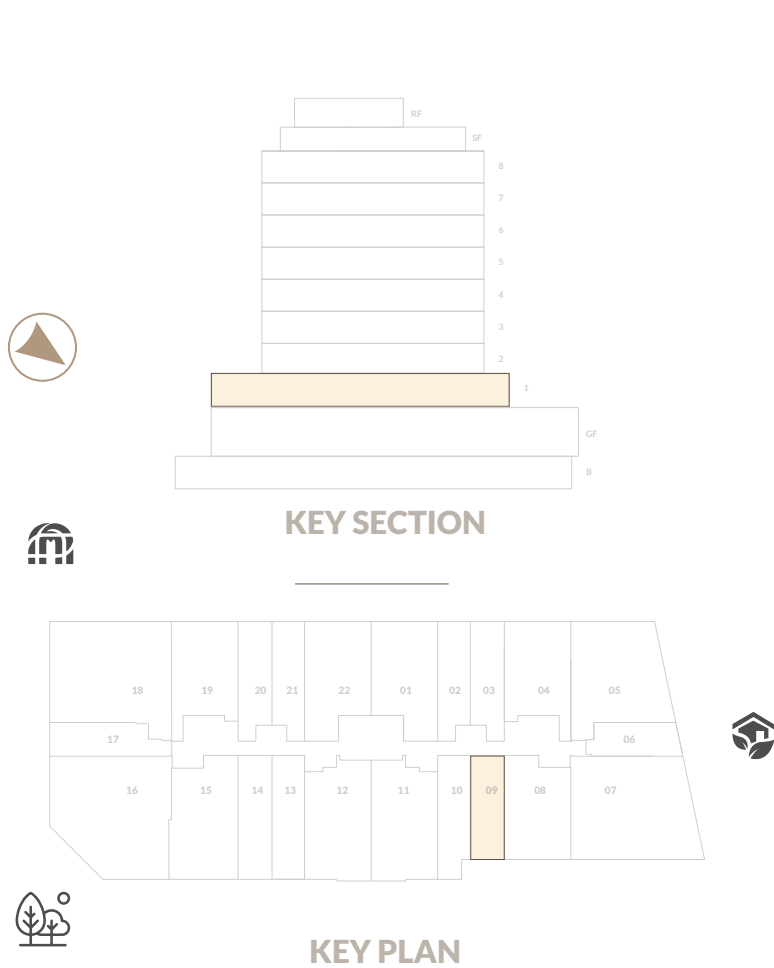

UNIT AREA: 349sq.ft.

BALCONY AREA: 231 sq.ft.

TOTAL AREA: 580 sq.ft.

STUDIO

TYPE

D

UNIT NO. 209 & 214

FLOOR 02 - 08

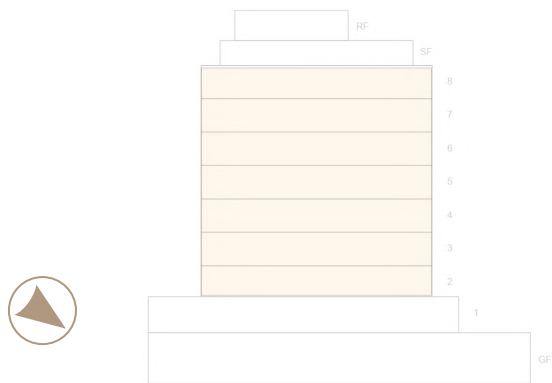

KEY SECTION

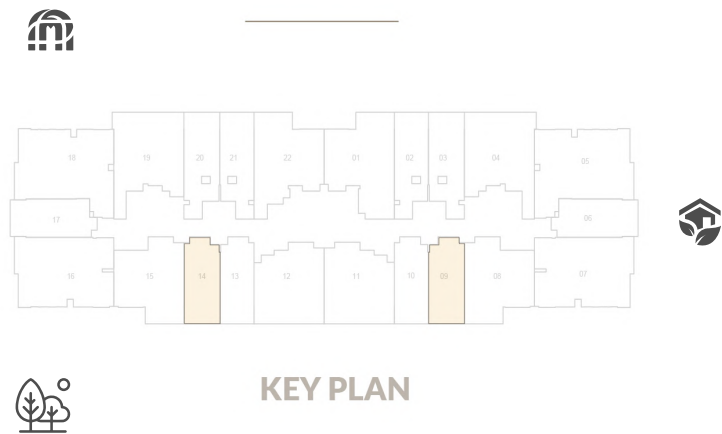

KEY PLAN



UNIT AREA: 349sq.ft.

BALCONY AREA: 87 sq.ft.

TOTAL AREA: 436 sq.ft.

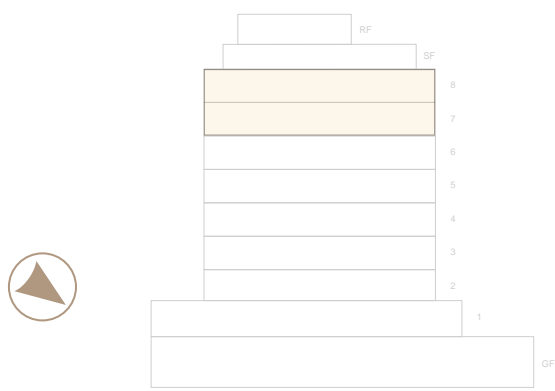

KEY SECTION

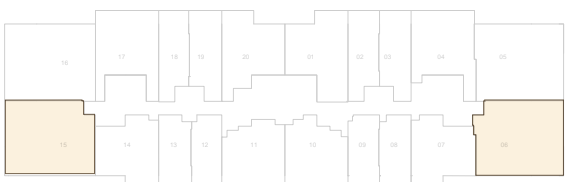

7TH FLOOR - LOWER PLAN

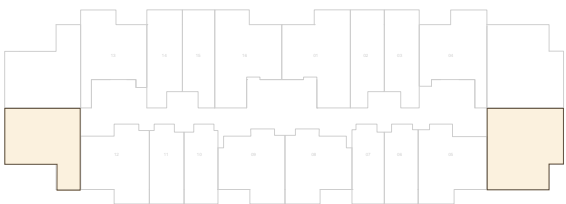

8TH FLOOR - UPPER PLAN



KEY PLAN



LOWER FLOOR PLAN



UPPER FLOOR PLAN

UNIT AREA: 1767sq.ft.

BALCONY AREA: 678 sq.ft.

TOTAL AREA: 2446 sq.ft.

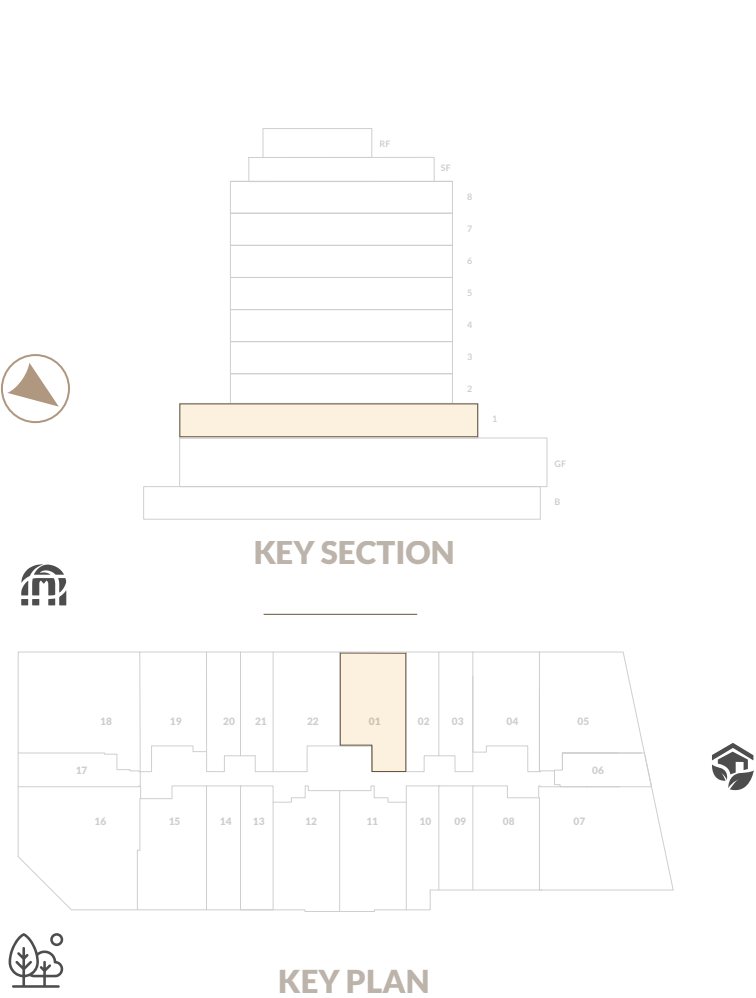

UNIT AREA: 753 sq.ft.

BALCONY AREA: 440 sq.ft.

TOTAL AREA: 1193 sq.ft.

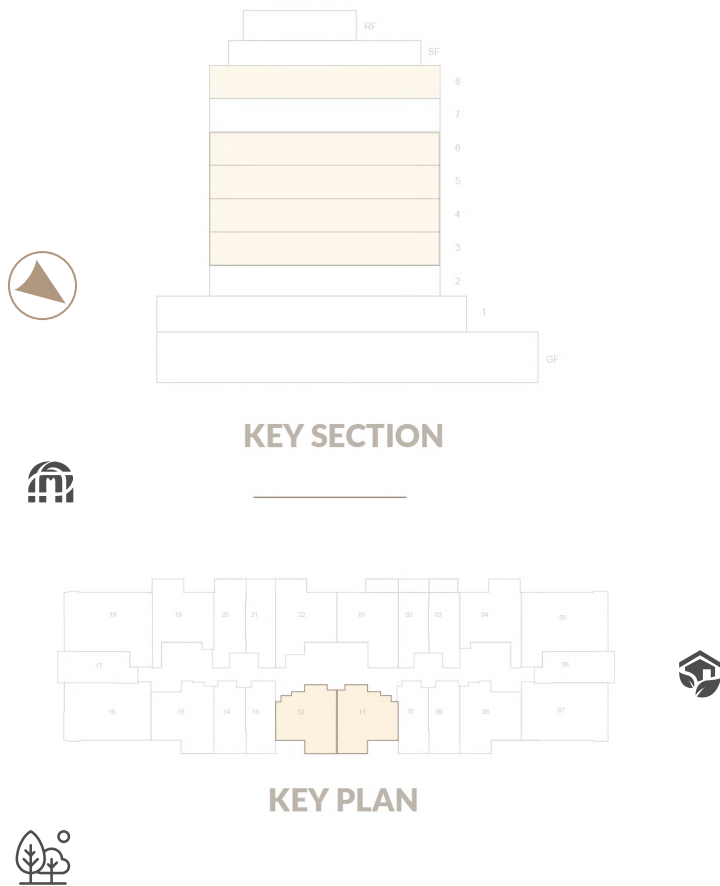

UNIT AREA: 589 sq.ft.

BALCONY AREA: 88 sq.ft.

TOTAL AREA: 677 sq.ft.

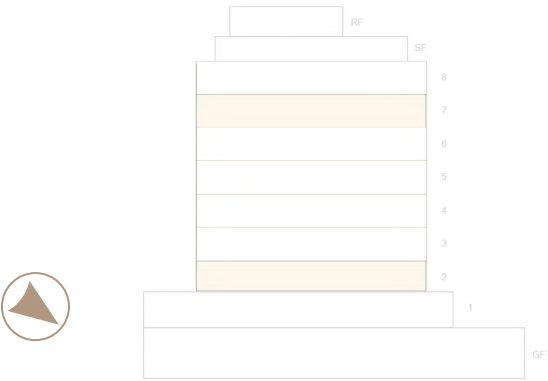

KEY SECTION

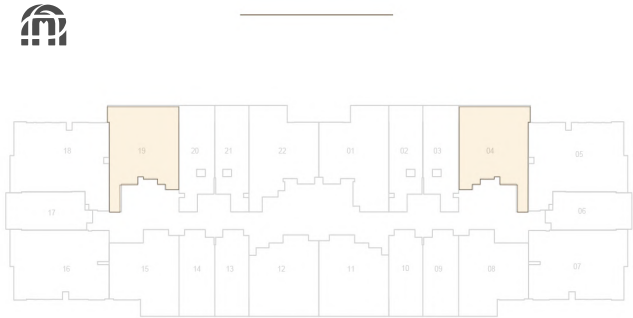

KEY PLAN



UNIT AREA: 673 sq.ft.

BALCONY AREA: 176 sq.ft.

TOTAL AREA: 850 sq.ft.

Payment Plan

2-Year Post Completion

Price Range

Units Types	Average Price
Studio	(AED 540,141 - 669,842)
1-Bedroom	(AED 793,384 - 1013,387)
2-Bedroom	(AED 1,050,186 – 1,540,825)
2 Bed Duplex	(AED 1,920,761 – 2,198,986)

Completion Date

Anticipated Completion Date - Q4 2025

Payment Plan

40% During Construction | 10% On Completion | 50% 2 Years Post Completion

Instalments	Time	Amount
Booking		AED 30,000
Down Payment	Within 7 Days	10% + 4%
2nd Instalment	1 Month After	10%
3rd Instalment	5 Months After	5%
4th Instalment	9 Months After	10%
5th Instalment	13 Months After	5%
6th Instalment	On Completion	10%
7-10th Instalment	Every 6 Months *4	12.5% *4

Reservation

How to book your unit

1. Clients Passport Copy
2. Signed CIF, with correct customer details, valid email address and phone number to issue the receipt/s
3. AED 30,000 EOI required to book units



Development that Transcends Beyond

Arabian Gulf Properties, an experienced developer renowned for striking residential & commercial developments, proudly presents Ghaff Land Real Estate Development L.L.C.

As a subsidiary of Arabian Gulf Properties, Ghaff Land Real Estate Development epitomizes exclusive excellence, in collaboration with Refine ensuring the project's foundation for undeniable quality, consistently surpassing Dubai's fierce real estate competition.

Developed by



refine

GHAFF LAND

— Residence —

800 REFINE
REFINEDUBAI.COM